



NEWTEC

# OPTICAL SORTING MACHINE

## CELOX-P-UHD, 4 LANES

NEW GENERATION  
CAMERA PLATFORM

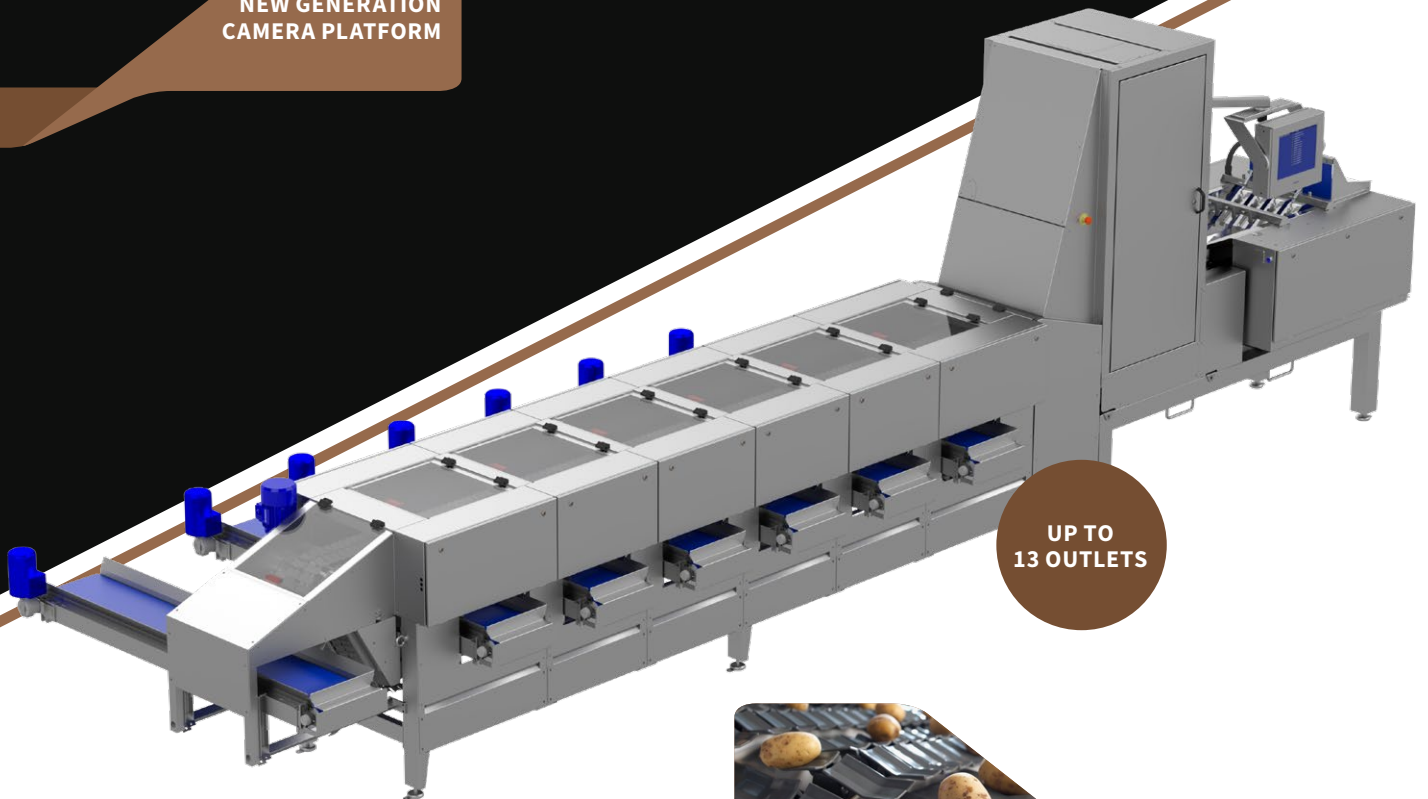

SPINAFLEX SECTION

## Simultaneous sorting by quality, size and shape



### Advantages

- Quality, size and shape sorting in one machine
- Accurate selection of high-value products
- Consistent quality output
- No need for mechanical pre-grading
- New generation camera platform
- Newtec WebServices for capturing of complete product information and remote servicing

### Application

- Potatoes



WEBSERVICES AVAILABLE  
FOR REMOTE SERVICING

## YOUR ADVANTAGES

- Optimal use of potatoes with unique and world leading quality sorting
- Increased throughput
- Increased operational reliability
- Low maintenance cost
- Patented technology
- Gentle product handling
- Labour cost savings
- Modular and upgradable system
- Easy access for cleaning and service
- New LED light panels
- New generation camera platform
- High colour consistency
- High resolution: 1 pixel = 0.16 mm<sup>2</sup>

## NEWTEC SOFTWARE

- Intuitive interface for configuring rules for sorting products by quality, size and shape
- Web-based user interface for convenient accessibility
- PLC connectivity for production line integration



## CELOX-P-UHD

## 4 LANES

Outlets	Length, mm (X1*)	Length, mm (X2*)
2+1	5135	1530
3+1	5755	2150
4+1	6375	2770
5+1	6995	3390
6+1	7615	4010
7+1	8235	4630
8+1	8855	5250
9+1	9475	5870
10+1	10095	6490
11+1	10715	7110
12+1	11335	7730

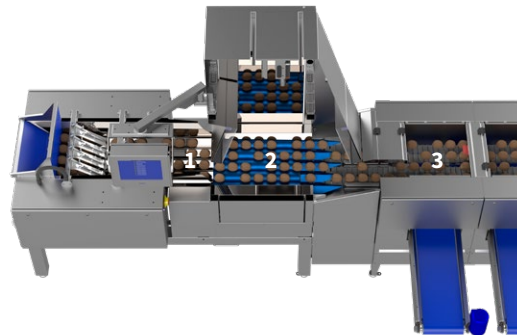

- 1) Singulation unit (product separation)
- 2) Inspection unit (camera vision system)
- 3) Sorting unit (Newtec Spinaflex system)

## OPTICAL SORTING MACHINE AVAILABLE WITH 2, 4 AND 12 LANES

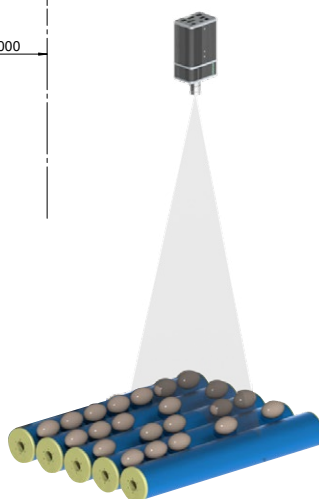
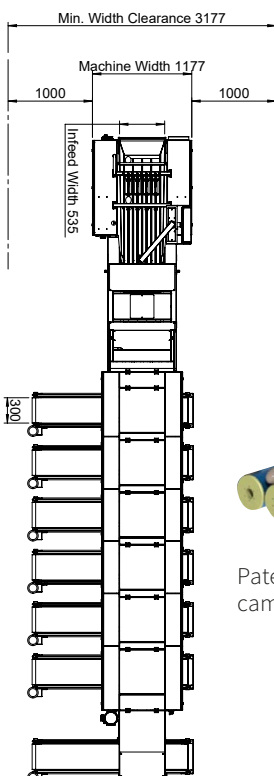

Patented vibrating rollers with camera controlled LED lights.

**Capacity** (4 lanes) From 1,5 to approx. 10 tonnes of product/h, depending on the size of the potatoes.

- > Potatoes of 30 g: ~ 1,8 tonnes/hour
- > Potatoes of 80 g: ~ 4,2 tonnes/hour
- > Potatoes of 300 g: ~ 8,4 tonnes/hour

**Electrical requirement** 3x400V+N+PE, 13A

**Environment** 5°C - 40°C/41°F - 104°F

**Weight** From 1200 kg - 3500 kg

**Air requirement**

**Min. pressure** 6 bar (0.6 Mpa)

**Consumption** 20-40 L/min.

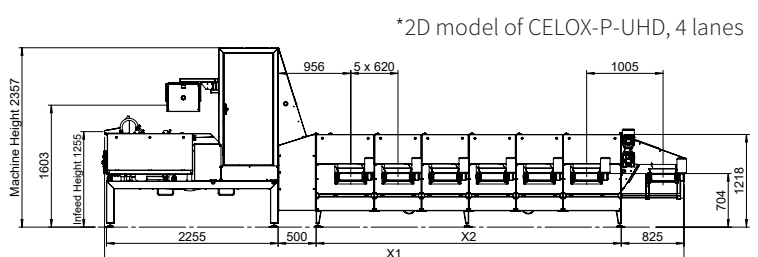

\*2D model of CELOX-P-UHD, 4 lanes